

mantra
on russell

*I will conference
in style*



Conference Packages

Mantra on Russell

222 Russell St
Melbourne VIC 3000



Mantra on Russell is a deluxe apartment-style hotel in the heart of cosmopolitan Melbourne – perfect for residential conferences, functions and small meetings.

We pride ourselves on our ability to stage well-organised business conferences, meetings and dinners that run like clockwork. If you're planning a big event, our function rooms are ideal, and our spacious apartments with separate lounge area are perfect for small meetings or to conduct interviews.

Whether for a board meeting for 12 or a cocktail event for 250, we are committed to ensuring that even the smallest detail goes to plan.

Our conference team allows you the freedom to tailor a function to your personal style and taste while working within a budget.

For delegates visiting from out of town, the hotel offers spacious accommodation with special guest packages available for conference delegates.



Offering a distinctly Melbourne experience, Mantra on Russell is ideally located in the heart of the city, within walking distance of Melbourne's famous shopping, entertainment and sporting event.



Explore cosmopolitan Melbourne from your stylish, contemporary-style apartment in the heart of the city. Mantra on Russell is within walking distance of Melbourne's famous entertainment district, leading tourist attractions and major sporting events. Stroll to theatres, trendy cafes and bars and enjoy a bite to eat in one of Melbourne's famous restaurants.

Accommodation:

221 Studio, One and Two Bedroom Apartments
4.5 star AAA Rating
100% non smoking

Guest facilities:

Onsite facilities include 24 hour reception, concierge, wireless broadband internet access, restaurant & bar, express check out, same day laundry & valet service, heated swimming pool & spa, sauna, gymnasium, daily housekeeping service, undercover parking and conference facilities

Room features:

All rooms feature air conditioning, full kitchen and laundry facilities (apartments only), kitchenettes in studio suites, hair dryer, ironing facilities, mini bar, coffee and tea making facilities, wireless internet access, in-house movies, stereo system, in-room safe & private balconies (some)

Bedding Configuration:

The Studio Suite features 1 queen or king zip or 2 single beds

The One Bedroom Apartment features 1 queen or king zip or 2 single beds

The Two Bedroom Apartment features 1 queen and 2 singles or 2 king zip or 4 single beds

Location :

Distance to Airport: 30 mins

Distance to Chinatown: 1 min (on foot)

Distance to Transport: 2 mins (on foot)

Distance to CBD: within

Distance to Melbourne Central: 5 mins (on foot)

Distance to Melbourne Exhibition & Convention Centre: 15 mins

Distance to Majesty's Theatre: 2 mins (on foot)



Ideally located on level one, Mantra One and Mantra Two offer a stylish and professional setting for your conference, with the flexibility of an intimate conference setting, a medium to large convention, a cocktail party or formal dinner.

Meeting Room Capacities

Room	Theatre	Cocktails	Banquet	Classroom	U-Shape	Boardroom	Cabaret
Mantra 1	120	150	80	70	24	30	60
Mantra 2	80	100	60	40	30	30	45
Mantra 1&2	180	250	130	70	-	-	-
Suite 608	15	15	10	9	9	12	-

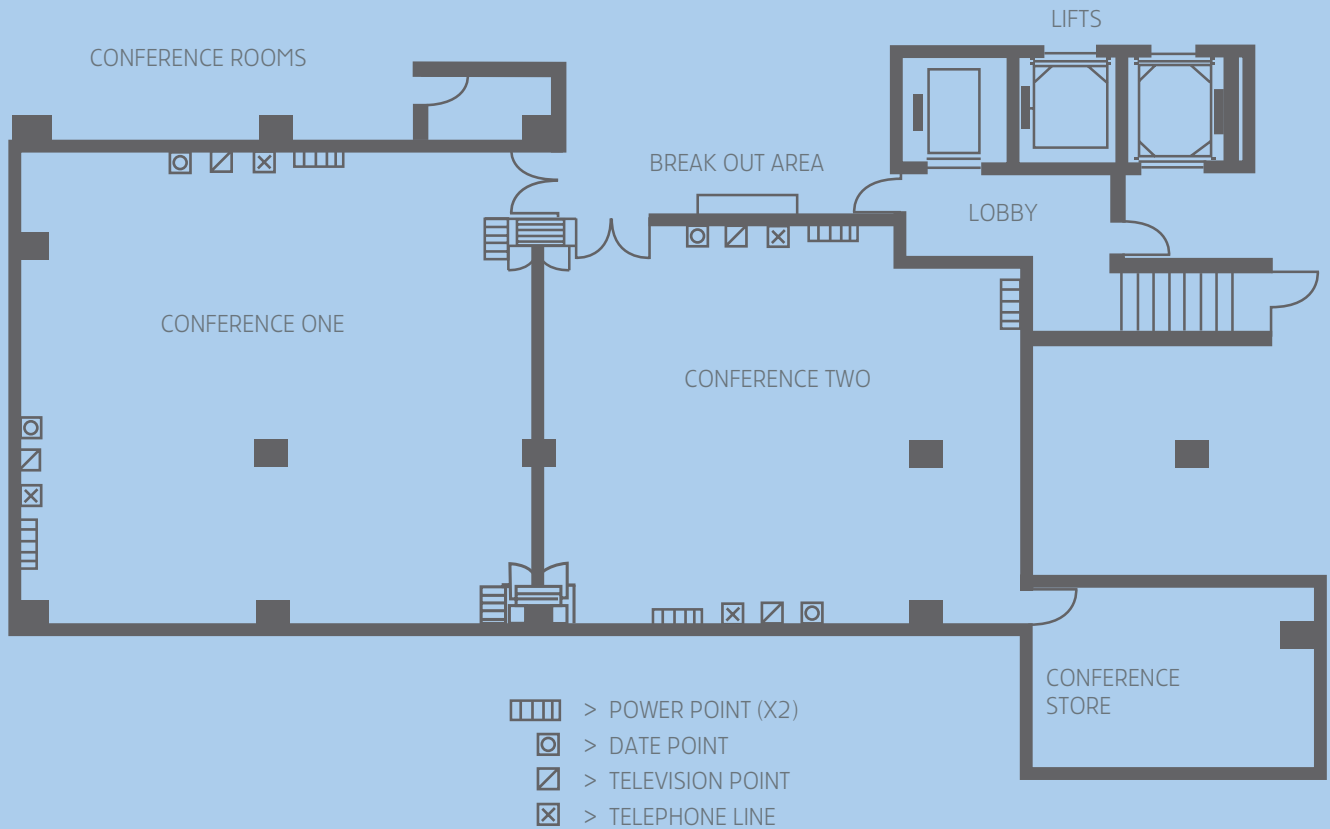

Floorplans are indicative only & may vary

Full Day Conference Package

- Conference Room Hire
- Complimentary screen, whiteboard, flip chart and facilitators kit
- Notepads & pens for all delegates
- Mantra confectionary bar and iced water
- Arrival tea and coffee
- Morning and Afternoon tea with bakery selection
- Buffet Lunch of 1 selection (choices include bagels, wraps, baguettes, pizzas, foccacias, or quiches and accompany two chef's seasonal salads, fruit platter, sweet suggestion or savoury pastries, orange juice, soft drink, tea and coffee)

Hot buffet lunch upgrade available for only an extra \$5.00 per person and includes 2 hot main dishes, 2 side dishes, 2 salads, 1 sweet option, orange juice, soft drink, tea and coffee.

Half Day Conference Packages also available.

Conference Day Packages are available for 15 or more delegates, otherwise individual catering options and room hire charges apply.



mantra
on russell

222 Russell St
Melbourne VIC 3000

Phone: 03 9915 2524

Fax: 03 9915 2598

Email: Simela.theo@mantra.com.au