

mantra  
ettalong beach

*I will conference  
by the beach*



## Conference Packages

Mantra Ettalong Beach  
53-54 The Esplanade  
Ettalong Beach NSW 2257



Mantra Ettalong Beach offers a unique experience on the Central Coast of New South Wales, 90 minutes north of Sydney. This spectacular development combines superbly appointed beachfront accommodation with exceptional conference facilities at the adjoining Ettalong Beach Club.

Excellent facilities, professional catering services, and an experienced event coordinator helps make your next event a success.

The unique conference centre can be configured for a range of function types and group sizes. The 700 square-metre ballroom can be utilised as a single room or as four smaller rooms and a foyer separated by sound-proofed operable walls. The ballroom seats 700 in theatre style or 500 banquet style.

Don't forget to include leisure pursuits in your plans. A wide variety of activities and attractions are available in the immediate area, including boating, golf, fishing, diving, kayaking, whale watching, surfing, horse riding, and leisurely strolls along the beach.

Email: [conference@ebmc.com.au](mailto:conference@ebmc.com.au)  
Phone: (02) 4343 0119 or (02) 4343 0121



Ettalong Beach Club adjoining Mantra Ettalong Beach offers excellent facilities for beachside conferences suitable for a range of function types and group sizes.

***The only thing we overlook is the beach!***



Offering 236 self contained studio, one and two bedroom apartments. The property is perfectly designed to enhance the surrounding waters, with an array of leisure and entertainment facilities making it the perfect seaside escape.



### Property facilities

activities desk  
 concierge  
 Jhalu day spa & fitness  
 heated swimming pool  
 whirlpool spa  
 gymnasium  
 sauna  
 24 hour reception  
 undercover parking



### Room features

air conditioning, cable tv, pay movies, card key access to guest room, cd player, tea and coffee making facilities, hair dryer, highspeed internet access (fees apply), in-room safe, iron and ironing board, kitchenette, spa bath (not available in wheelchair accessible rooms), shower and laundry facilities.



### Location

beautiful beaches  
 stunning national parks  
 excellent year round climate  
 90 minutes north of Sydney

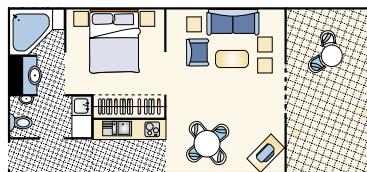

Sample one bedroom floor plan

*Mantra Ettalong Beach has a range of studio, one bedroom and two bedroom accommodation rooms. All rooms have balconies, spa baths and most have water views. There is a resort style pool and a state of the art gymnasium for guests' use.*



# Conference Packages and Capacities

Offering a flexible conference solution at the adjoining Ettalong Beach Club, the resort offers the ideal location for a beachside conference or event.

Excellent facilities, professional catering services, and an experienced on-site meeting coordinator at Ettalong Beach Club will make your function a success.

## Conference Package

**Full day delegate package**  
**\$65 per delegate**

Full day delegate package with a working lunch \$55 per delegate

**Half day delegate package**  
**\$55 per delegate**

Half day delegate package with a working lunch \$45 per delegate

## Conference Package inclusions

- Room hire & set up.
- Arrival tea and coffee
- Full buffet lunch
- Freshly brewed coffee, a selection of teas, herbal infusions and chefs selection of morning & afternoon tea
- Note pads, pens, fresh fruit bowl, bottled water and mints
- Standard audio visual screen (6x6), flipchart, whiteboard and markers. (1 per conference)

## Additional Information

- Minimum numbers apply.
- Groups less than 20 will incur room hire charge.
- Breakout room hire charge from \$250 per room
- Wireless Internet services are available on request - \$35 per connection
- Stage from \$200.00 per day
- Dance floor from \$100.00 per day
- AV equipment is available on request, prices on application

## Conference Room Capacities

Room Name	Area (sqm)	Cocktail	Theatre	Classroom	Banquet	Boardroom	Cabaret
The Patonga Room (1)	150	200	120	70	90	30	72
The Ettalong Room (2)	130	150	90	50	60	26	48
The Seaview Room (3)	160	200	120	70	90	30	80
The Pearl Beach Room (4)	160	200	120	70	90	30	80
Ettalong Ballroom (1+2)	280	350	200	110	160	-	128
Seaview Ballroom (3+4)	320	400	250	140	200	-	160
Broken Bay Ballroom (1+2+3+4)	700	900	700	450	500	-	400
Peninsula Lobby	100	150	90	50	60	-	48
The Board Room	-	-	30	20	-	10	-
The Pretty Beach Room	108	150	-	-	80	-	-
Penthouse 701	-	40	-	-	-	10	-

The height of all rooms is 3.2m.

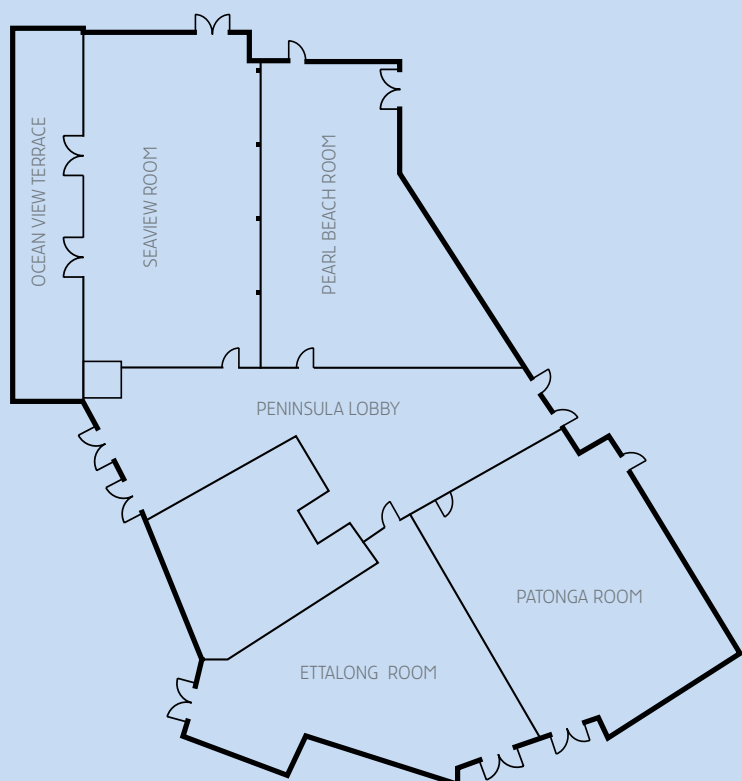



## Team Building and Leisure Pursuits

Mantra Ettalong Beach provides a beachfront location which is ideal for team building activities. Whether you require specific team building activities to complement your conference theme or a variety of relaxation options as a reward for busy delegates, Mantra Ettalong Beach is ideally situated to make the most of your groups recreation time. Below is a list of team building professionals we work with and some ways to take advantage of our coastal location.

### **Malcolm McLeod**

"The handwriting guy," is one of the most experienced and dynamic speakers on the planet. Malcolm started his working life as a member of the Queensland Police Force. Malcolm studied hand writing as a method of communication and a method to analyse the inmates. Malcolm specialises in Team Building & Training, Change & Growth Facilitation, Conference Energisers and MC, Motivational Keynotes, Self Leadership Keynotes and Secrets, home-truths and star qualities revealed in YOUR handwriting! Let Malcolm make the difference at your conference.

Malcolm McLeod Office : Phone/Fax: 1800 249 351  
[www.MotivationWorldWide.com](http://www.MotivationWorldWide.com)  
[www.ConferenceSpeakersAustralia.com.au](http://www.ConferenceSpeakersAustralia.com.au)

### **Pinnacle Team Events**

One of Australia's leading providers of Team Building Events and Motivational Presentations. Pinnacle adopt a unique approach – "We don't do Group Hugs!" Our team activities are professional, entertaining, hands-on and most importantly fun! Pinnacle have over 20 years' experience in organising events and our range of options spreads from Wine Blending to Beach Olympics, from Laser Clay Shooting to The Amazing Race, from Casino Nights to Corporate Drumming – we have options to cater for all groups, budgets and time frames.

Let Pinnacle make the difference at your next conference – call Lincoln or Will today on (02) 4962 5034 or email [info@pinnacleteamevents.com.au](mailto:info@pinnacleteamevents.com.au)

### **PNF**

PNF Learning & Development are the professionals in team building and training programs. Our activities which include: boot camp, trivia night, amazing race and 'operation lost attaché case', incorporate components of fun and learning to highlight the objectives of your conference, or to re-encourage your team. PNF have a new range of team challengers that provides the opportunity for your company to demonstrate its corporate social responsibly. Activities that not only allow team members to work more efficiently but give something back to the community.

For a comprehensive list of what PNF can offer, please visit our website or phone us direct for more information.

T: 02 4384 7214      [www.pnf.com.au](http://www.pnf.com.au)

### **Learn to Surf**

Step out of the conference and let's feel the sand between your toes and the smell of salt in the air. You can experience the fun of paddling a softboard in the ocean and feel the thrill of riding a wave and high five colleague, or for a program a little more relaxed, enjoy a casual surfing experience even if you've never seen a surfboard before, we can tailor a program to your needs as long as fun is included.

Contact Terry Webster  
T: 02 4325 8123  
[www.gosford.nsw.gov.au](http://www.gosford.nsw.gov.au)

### **Jhalu Day Spa and Fitness**

If you want to increase: Productivity and customer satisfaction, Differentiate your company in the marketplace, Build customer relationships, Say "Thank You" for a job well done, Re-ignite employee motivation, Release some staff stress during a busy period, Have a great laugh Then a Fun Team Building Activity is the way to go. Our sessions are flexible; they are great as a one off or on a regular basis. Staff can break out and have a great time for a while and then get back into work with a rejuvenated outlook options include Yoga, stretch and revive, day spa treatments, The amazing Race Ettalong Style and beach activities.

Please contact Jhalu on  
T: 02 4341 3370  
[www.jhalu.com.au](http://www.jhalu.com.au)

### **Glenworth Valley**

#### **Outdoor Adventure**

Enjoy a range of exciting adventure activities at Glenworth Valley, Australia's largest horse riding and outdoor adventure centre.

Choose from horse riding, abseiling, mountain biking, kayaking, laser skirmish and quad biking or why not try one of our fantastic adventure packages.

T: 02 4375 1222  
[www.glenworth.com.au](http://www.glenworth.com.au)



mantra  
ettalong beach

53-54 The Esplanade  
Ettalong Beach NSW 2257

Phone: 02 4343 0121  
Email: [conference@ebmc.com.au](mailto:conference@ebmc.com.au)

[www.mantraettalongbeach.com.au](http://www.mantraettalongbeach.com.au)